



Electrolux
PROFESSIONAL

Standard Preparation 1200 mm Soaking Sink for Dishwasher with 1 Bowl

ITEM # _____

MODEL # _____

NAME # _____

SIS # _____

AIA # _____



133191 (NSBD1217R)

Sink Unit for Undercounter
Dishwasher with 1 bowl
W400xD500xH300mm and
right hand drainer, 1200mm

Short Form Specification

Item No. _____

Made from 304 AISI stainless steel. The 50mm high worktop in 304 AISI stainless steel, 1mm in thickness, is sound-deadened and has an overflow rim and welded corners. Integral rear upstand, h=100mm, with 10mm radius. Allround apron. Square section legs 40x40mm on 1" height-adjustable feet (+/-20mm). Bowl W400xD500xH300mm with overflow pipe and 2" drain hole; right hand drainer. An undercounter dishwasher can be placed under the drainer.

Main Features

- Sturdiness, stability and reliability of table accurately tested.

Construction

- Sink tops easily slotted onto the legs and taps are easily installed from the rear.
- Square section legs and 40 mm height-adjustable feet in 304 AISI stainless steel.
- 100 mm upstand with 8 mm radiused corner and 13 mm deep, designed to be used against a wall.
- 50 mm worktop in 304 AISI stainless steel, 10/10 in thickness with overflow rim along the top.
- Bottom part of drain left free to house an undercounter dishwasher.
- Wide range of taps are available to suit every need.
- Drainage area suitable for drying operations
- 100 mm upstand with 10 mm radiused corner and 13 mm deep, designed to be used against a wall.

Optional Accessories

- Set of 4 wheels (2 with brake) PNC 855150 ☐
d. 100mm for tables and sinks
(total height on wheels= 993 mm)
- Elbow operated mixer tap with PNC 855322 ☐
spout 3/4", single hole
- Elbow operated mixer tap with PNC 855323 ☐
short spout 3/4", single hole
- Foot operated mixer tap (hot PNC 855328 ☐
and cold) with spout 3/4"

APPROVAL: _____



Experience the Excellence
www.electroluxprofessional.com

Standard Preparation 1200 mm Soaking Sink for Dishwasher with 1 Bowl

Front

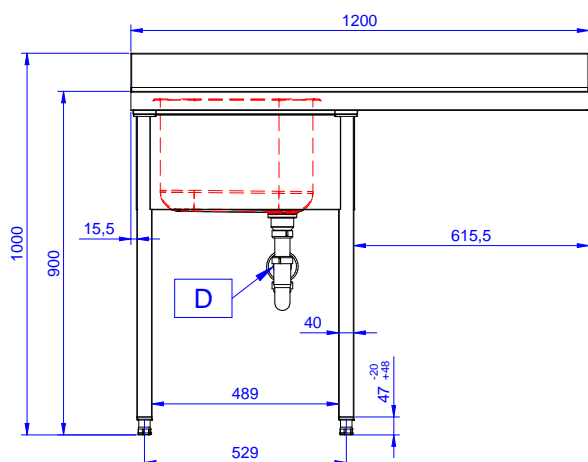

Side

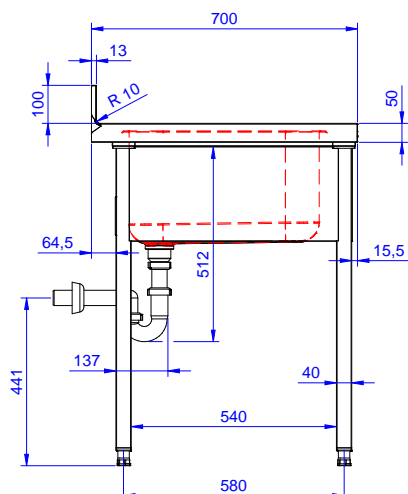

Top

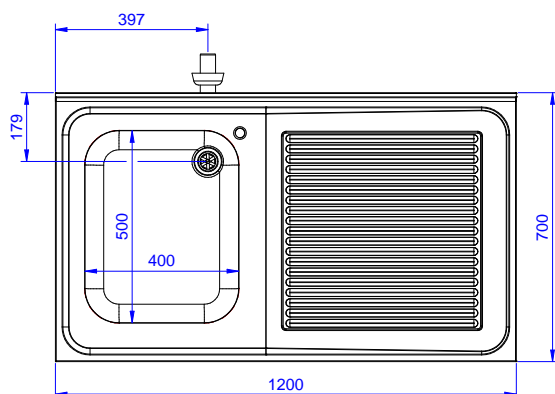

Key Information:

| | |
|------------------------------|--------------|
| External dimensions, Width: | |
| 133191 (NSBD1217R) | 1200 mm |
| External dimensions, Depth: | 700 mm |
| External dimensions, Height: | 1000 mm |
| Upright Dimensions, Height: | 100 mm |
| Upright Dimensions, Depth: | 13 mm |
| Upright Dimensions, Radius: | R=10 |
| Bowls number | 1 |
| Bowl dimensions | 400x500xH320 |
| Net weight: | 32.3 kg |

Standard Preparation
1200 mm Soaking Sink for Dishwasher with 1 Bowl

The company reserves the right to make modifications to the products without prior notice. All information correct at time of printing.